

Las Cruces Extra-territorial Zoning Authority Las Cruces Extra-territorial Zoning Commission

CITY OFFICES

City Planning Department
700 N. Main Street
P.O. Box 20000
Las Cruces, NM 88004
Phone: (575) 528-3043
Fax: (575) 528-3155

COUNTY OFFICES

County Planning Department
Doña Ana County Government Center
845 North Motel Blvd.
Las Cruces, NM 88007
Phone: (575) 647-7350
Fax: (575) 525-6131

TO: Extra-Territorial Zoning (ETZ) Authority
FROM: Lorenzo Vigil, Planning Tech Senior *LV*
RE: Minor and Large Land Area Subdivision Applications for August 2013
DATE: September 3, 2013 M-13-219

The following minor subdivision applications were received for the month of August 2013. There was no large land area subdivision applications received during this time. Any minor subdivision and large land area subdivision applications received after August 31, 2013, will be reflected on the status report for the next scheduled ETZ Authority meeting.

cc: Katherine Harrison Rogers, Senior Planner
Robert Kyle, Building & Development Services Administrator *RK*
VMB Vincent Banegas, Community Development Deputy Director

1. Case ETZS-13-024: Loomis Road Subdivision

Vicinity Map

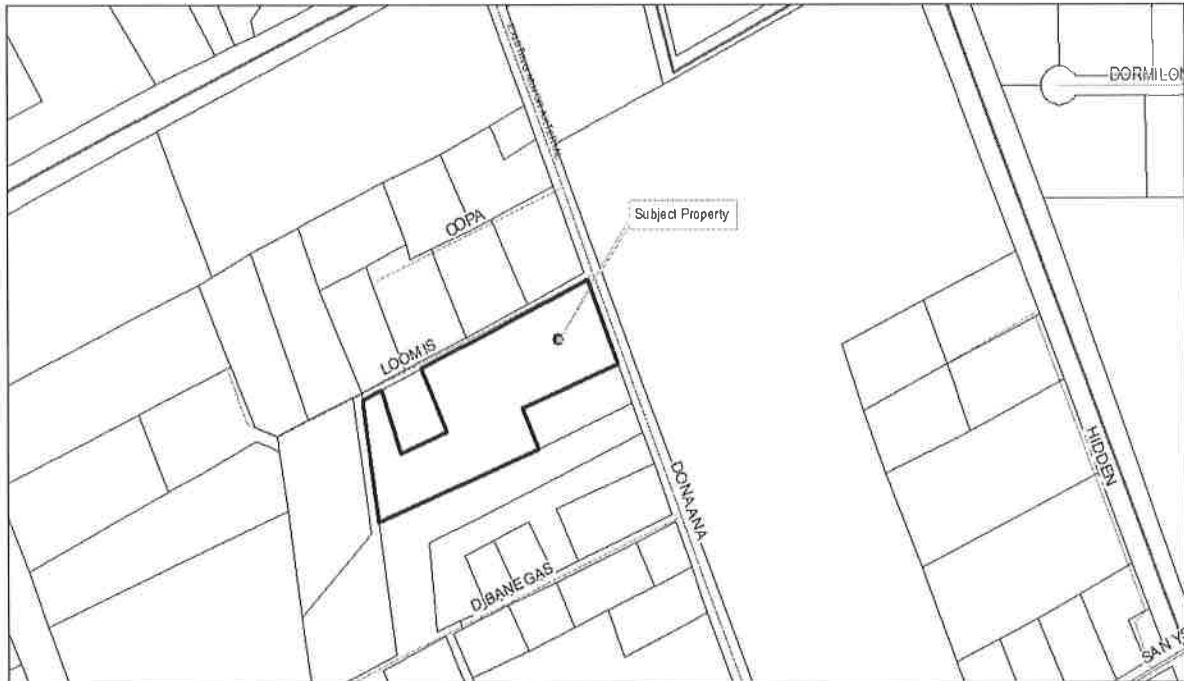

- Submitted August 9, 2013.
- Subdivision application is still in review and the reviewing parties currently not approving are: CLC Planning, CLC Engineering, CLC Surveyor, CLC Land Management, DAC Planning, DAC Engineering, DAC Flood
- Proposes 2 lots on 4.15 ± acres.
- Zoned ER3M, minimum lot size 1 acre.
- Located at SW corner of Loomis Rd., & Dona Ana Rd.
- Submitted by Paul Pompeo for Steven D. Zins and Monica S. Magallanes property owners.